

NOTE:

- 1 - ENSURE THAT ALL ORGANIC MATTER IS REMOVED FROM THE EXCAVATED AREA PRIOR TO PLACING AND COMPACTION OF BASE MATERIALS.

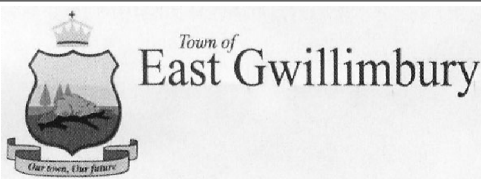

STANDARD DUTY ASPHALT PAVING

STANDARD DETAIL

APPROVED	DWG. No.
REVISION No.	301
DATE	
2009	

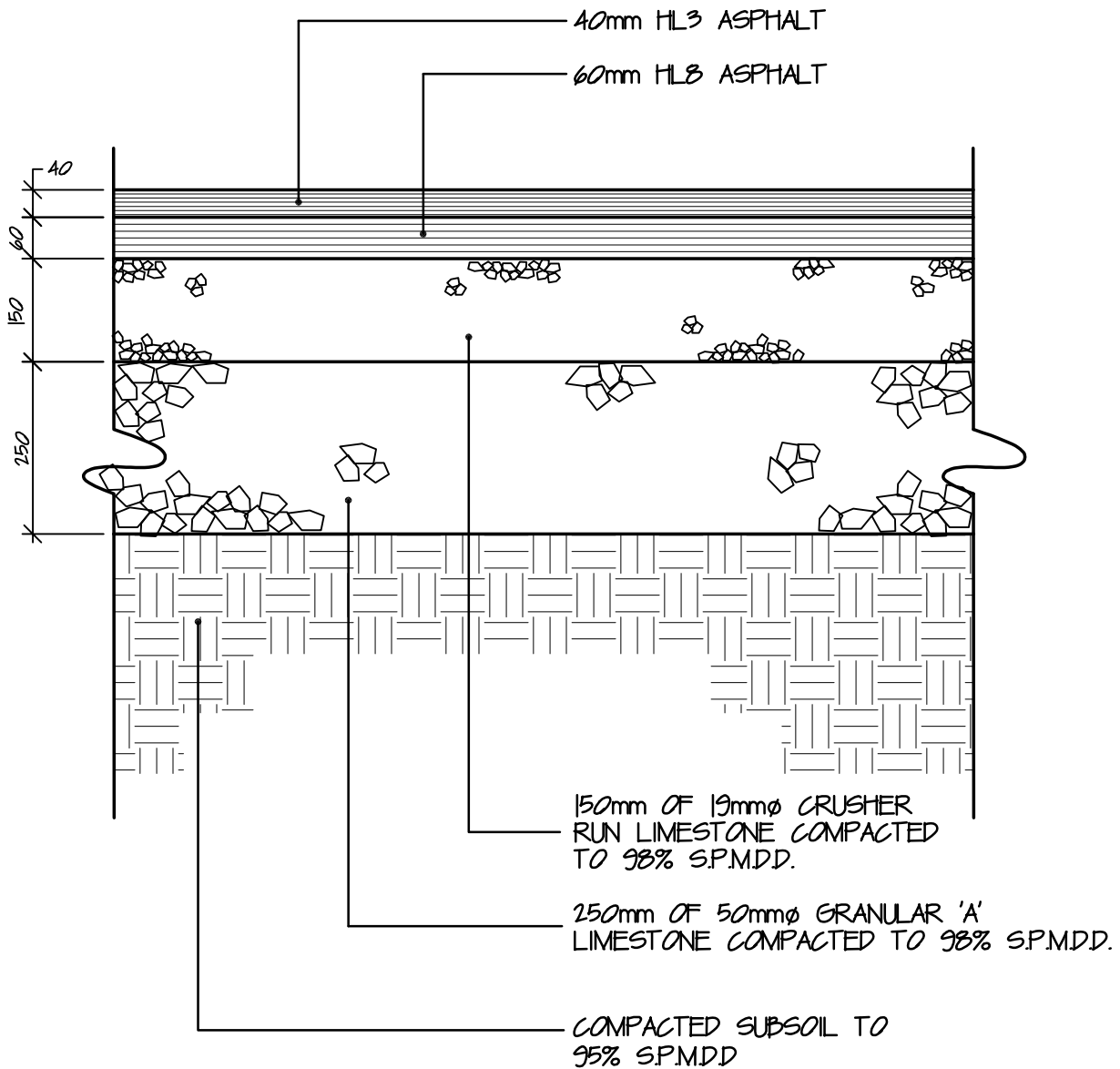

NOTE:

ENSURE THAT ALL ORGANIC MATTER IS REMOVED FROM THE EXCAVATED AREA PRIOR TO PLACING AND COMPACTION OF BASE MATERIALS.



Town of
East Gwillimbury

**HEAVY DUTY
ASPHALT PAVING**

STANDARD DETAIL

APPROVED

DWG. No.

REVISION No.

302

DATE

2009

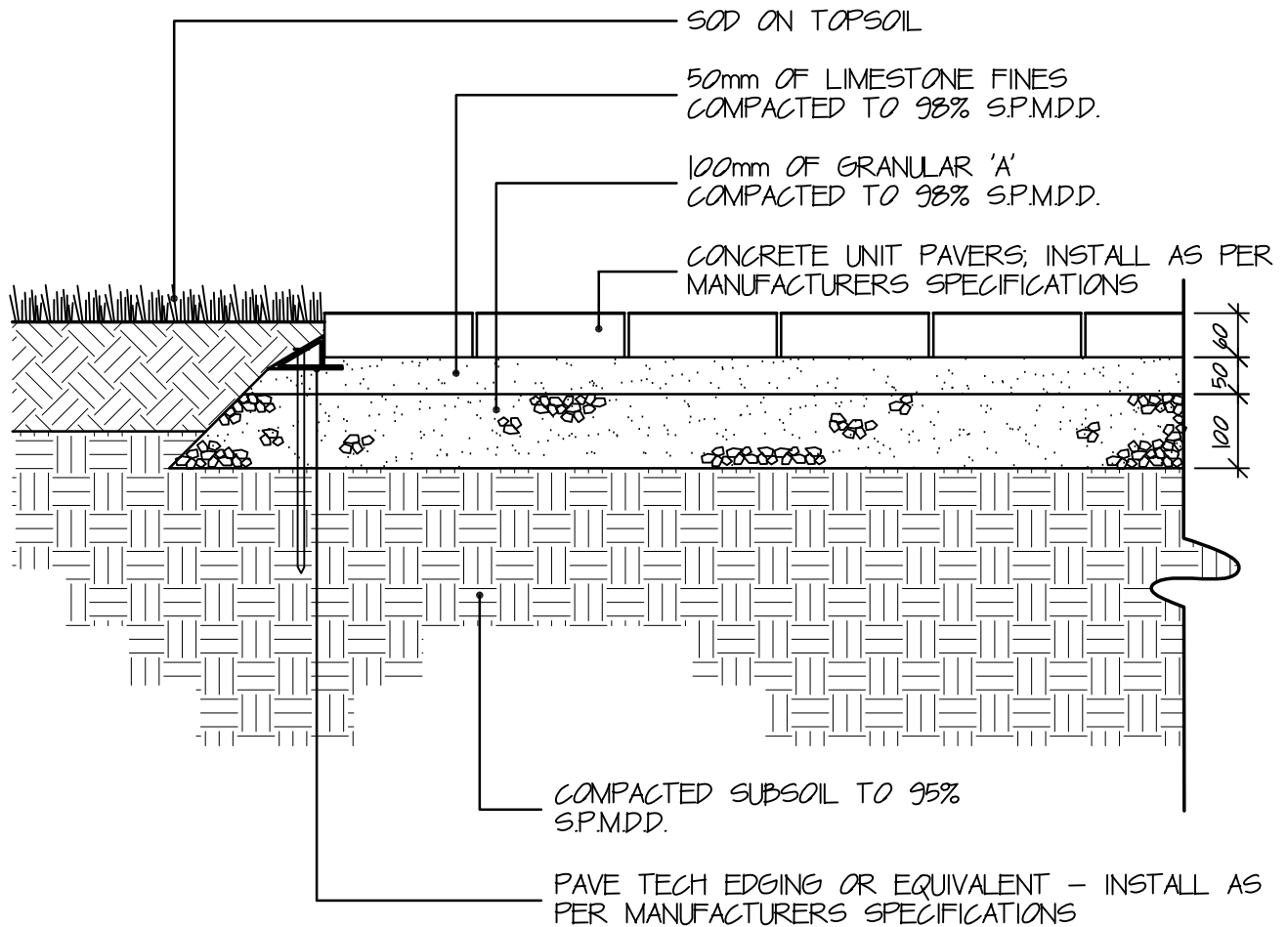

NOTE:

1-ENSURE THAT ALL ORGANIC MATTER IS REMOVED FROM THE
EXCAVATED WALKWAY PRIOR TO PLACING LIMESTONE FINES.

2-PROVIDE GEOTEXTILE MEMBRANE AS DIRECTED IN AREAS WHERE BASE
MATERIALS MAY BE IN CONTACT WITH CLAY OR DEEP LOAM SOILS.



Town of
East Gwillimbury

**STANDARD DUTY UNIT
UNIT PAVING**

STANDARD DETAIL

APPROVED

DWG. No.

REVISION No.

303

DATE

2009

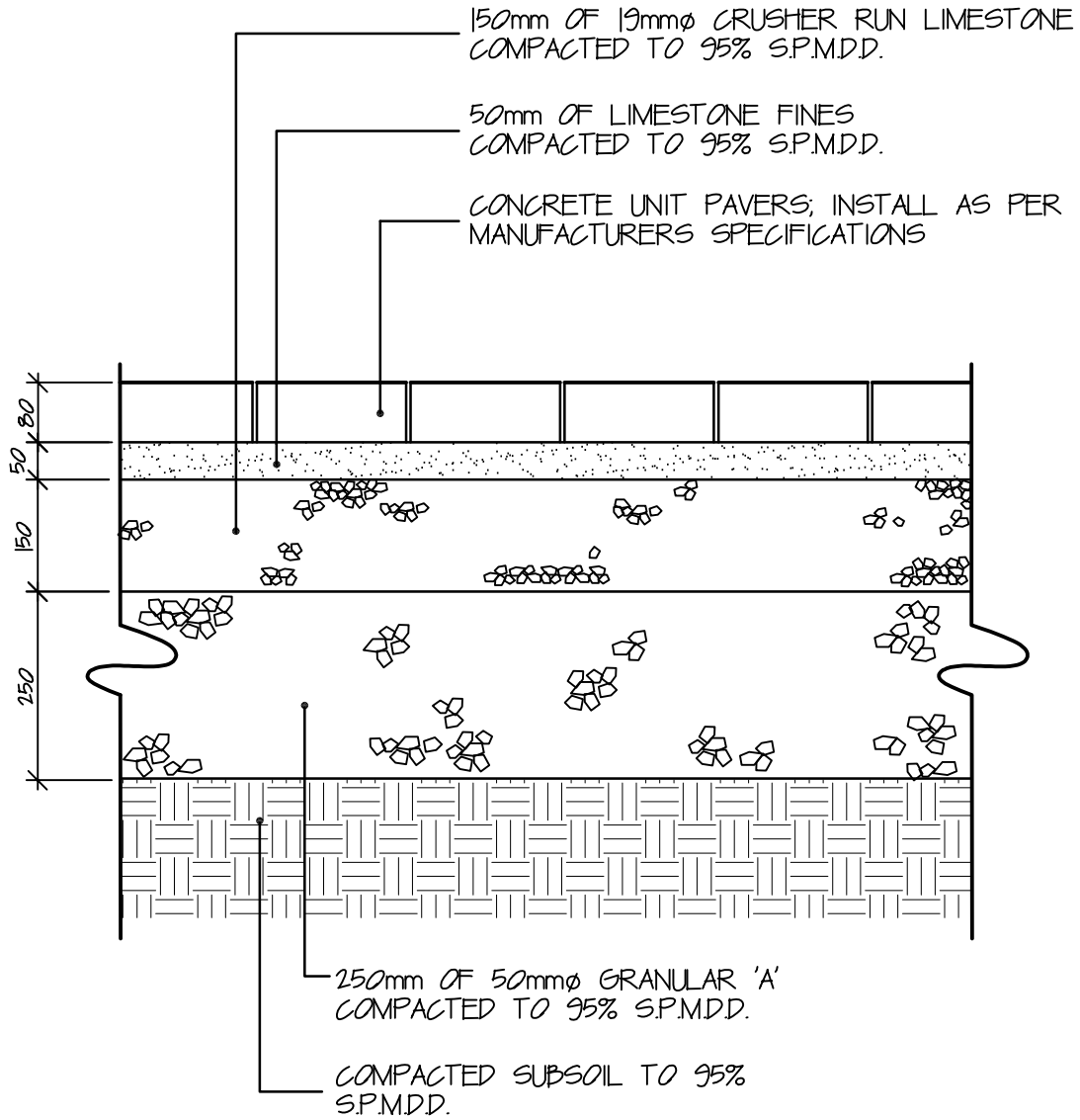

NOTE:

ENSURE THAT ALL ORGANIC MATTER IS REMOVED FROM THE
EXCAVATED BASE AREA PRIOR TO PLACING GRANULAR.



Town of
East Gwillimbury

**HEAVY DUTY
UNIT PAVING**

STANDARD DETAIL

APPROVED

DWG. No.

REVISION No.

304

DATE

2009

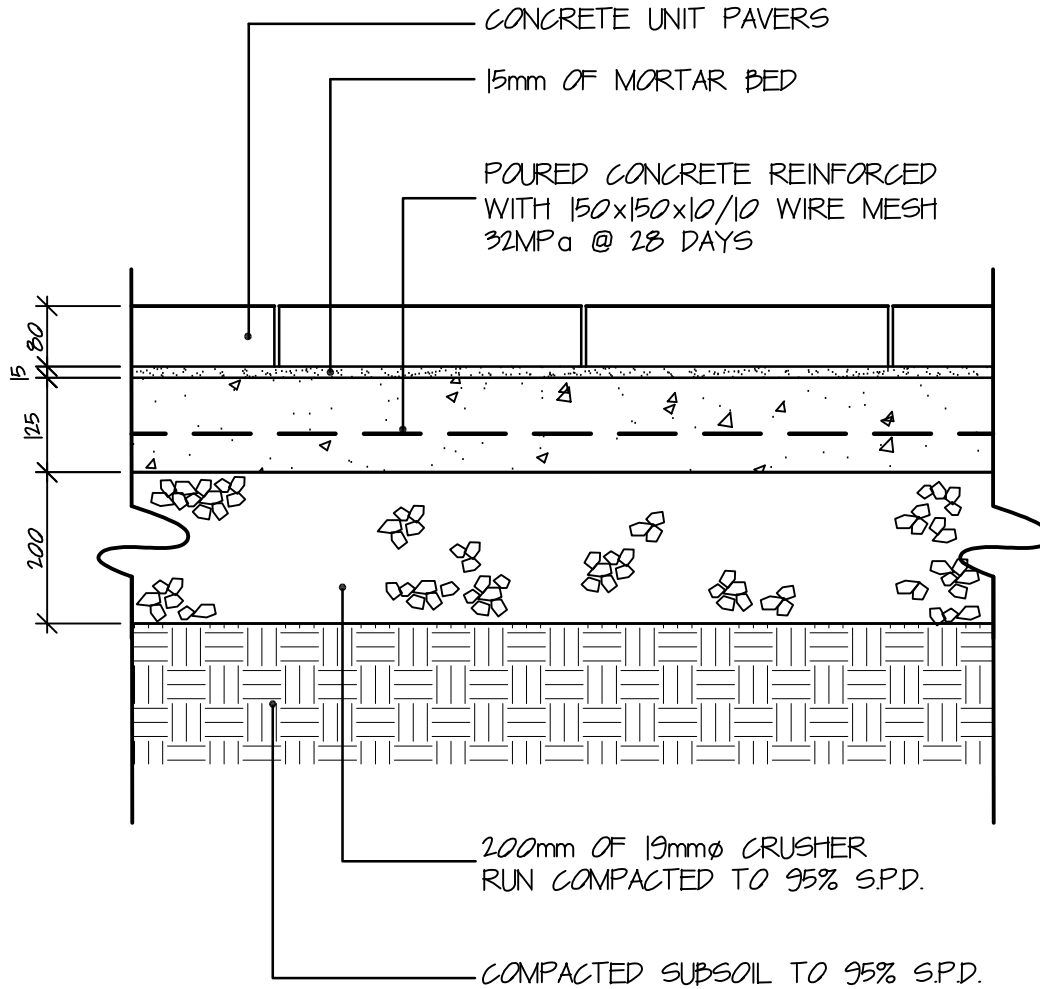

NOTE:

ENSURE THAT ALL ORGANIC MATTER IS REMOVED FROM THE EXCAVATED BASE AREA PRIOR TO PLACING LIMESTONE FINES.



Town of
East Gwillimbury

**UNIT PAVING ON
CONCRETE BASE**

STANDARD DETAIL

APPROVED

DWG. No.

REVISION No.

305

DATE

2009

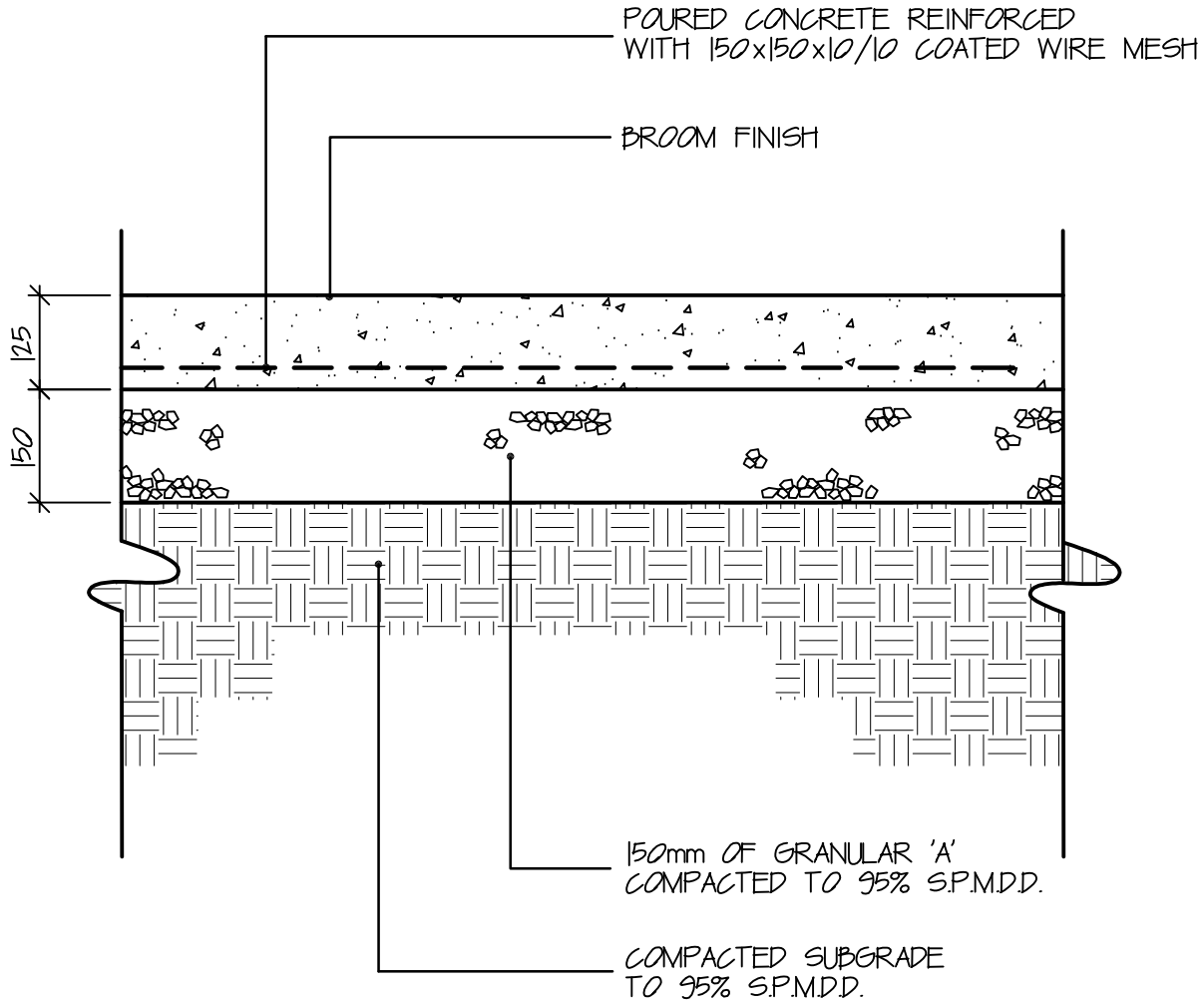

NOTE:

- 1-CONCRETE SHALL BE 32 MPa AT 28 DAYS WITH 6% AIR ENTRAINMENT AND A MINIMUM CEMENT CONTENT OF 340kg/m.
- 2-13mm DEEP SAW JOINTS TO BE LOCATED AT 2000mm INTERVALS, SEE SPECIFICATIONS.
- 3-CURING MEMBRANE (WHITE PIGMENTED) TO BE APPLIED AT THE RATE OF 4sq.m/L.
- 4-EXPANSION JOINTS TO BE LOCATED AT 12000mm INTERVALS, AND WHERE CONCRETE PAVING ABUTS OTHER STRUCTURES OR BUILDINGS. EXPANSION JOINT INFILLED WITH 12x175mm ASPHALT FELT BOARD.



Town of
East Gwillimbury

**STANDARD DUTY
CONCRETE PAVING**

STANDARD DETAIL

APPROVED

DWG. No.

REVISION No.

306

DATE

2009

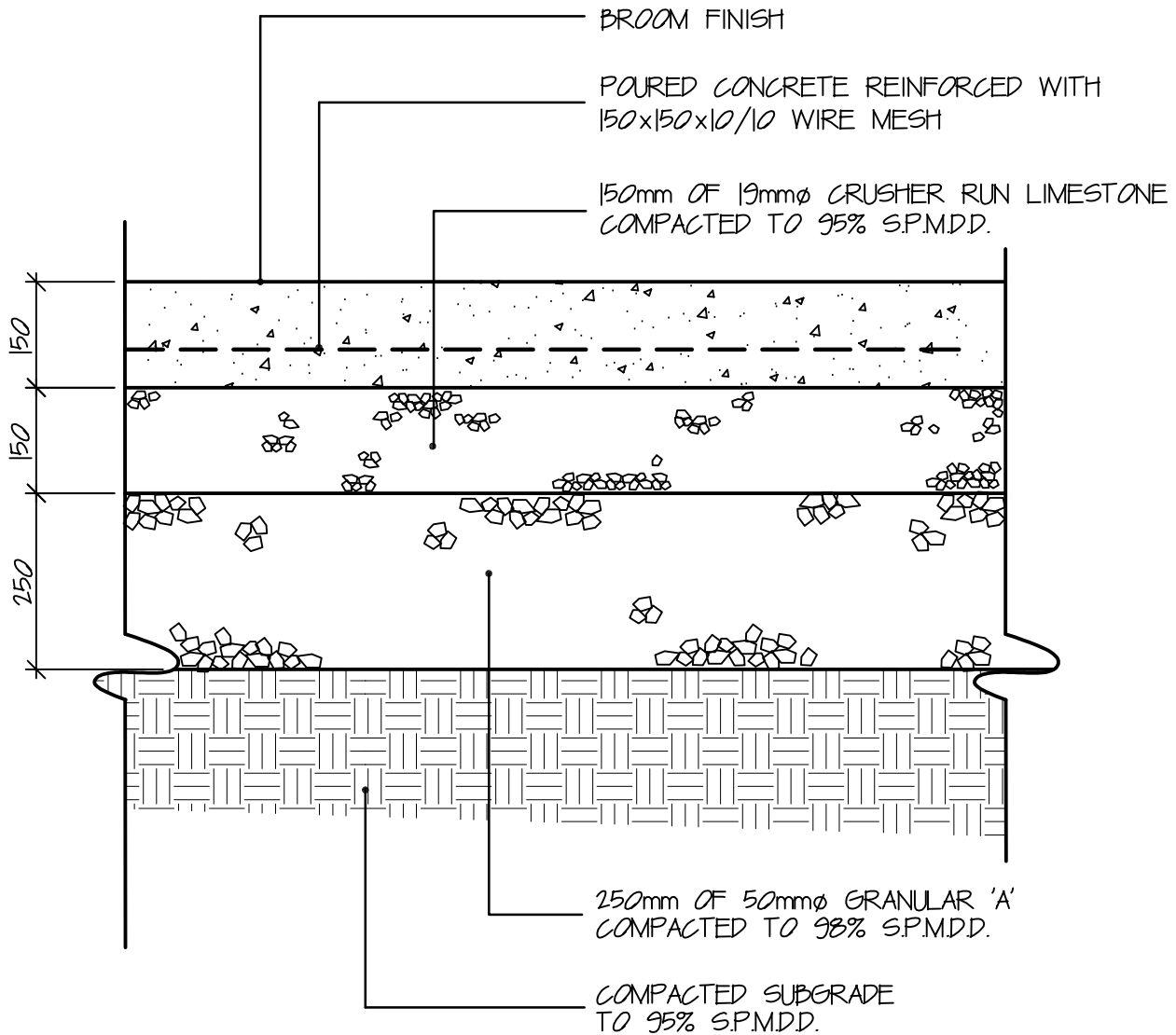

NOTE:

- 1-CONCRETE SHALL BE 32 MPa AT 28 DAYS WITH 6% AIR ENTRAINMENT AND A MINIMUM CEMENT CONTENT OF 340kg/m.
- 2-13mm DEEP SAW JOINTS TO BE LOCATED AT 2000mm INTERVALS, SEE SPECIFICATIONS. LAYOUT TO BE APPROVED ON SITE BY LANDSCAPE ARCHITECT.
- 3-CURING MEMBRANE (WHITE PIGMENTED) TO BE APPLIED AT THE RATE OF 4sq.m/L.
- 4-BITUMINUS FIBRE EXPANSION JOINTS WITH CAULKING/SEALER 12000mm O.C.



Town of
East Gwillimbury

**HEAVY DUTY
CONCRETE PAVING**

STANDARD DETAIL

APPROVED

DWG. No.

REVISION No.

307

DATE

2009

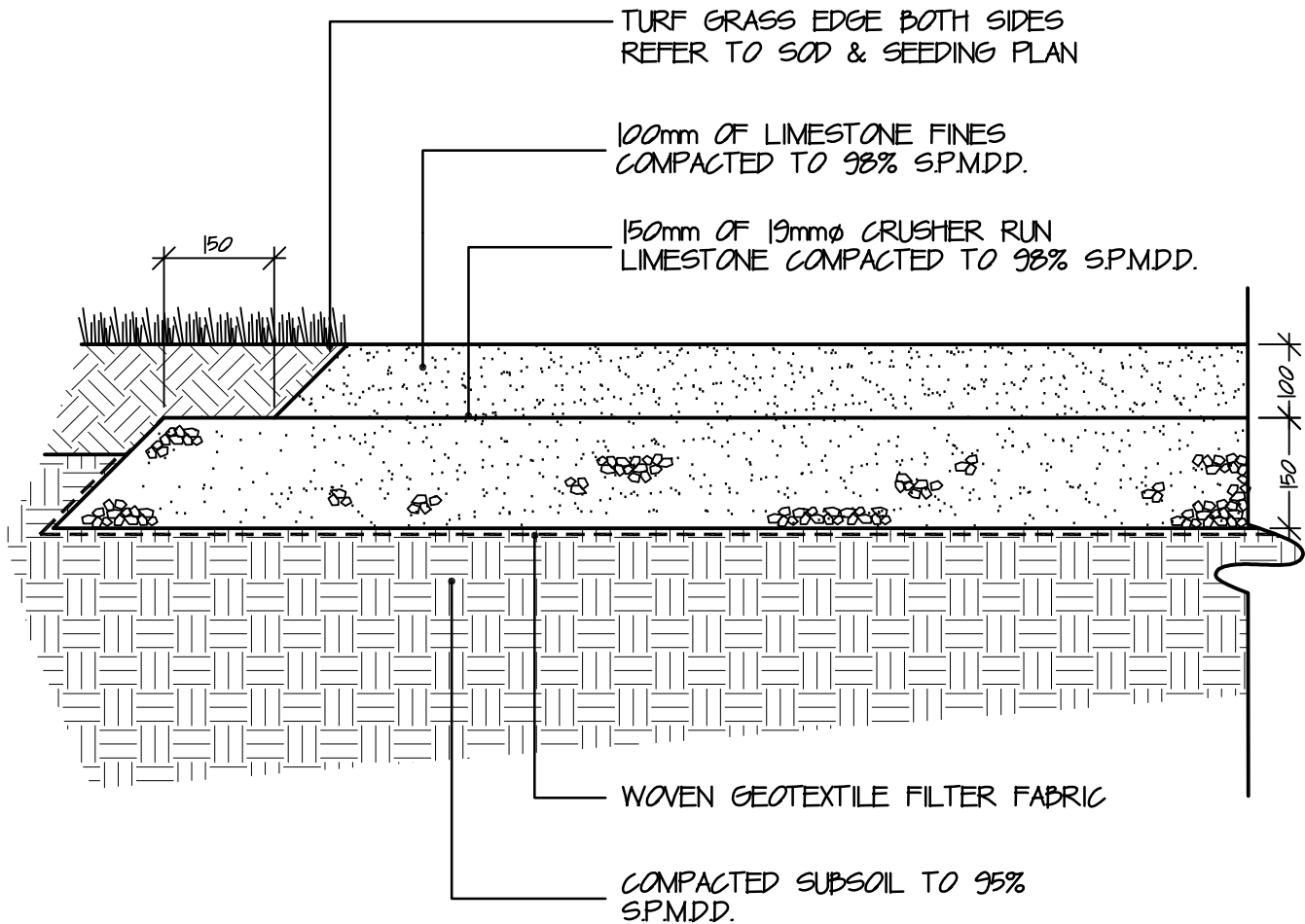

NOTE:

ENSURE THAT ALL ORGANIC MATTER IS REMOVED FROM THE
EXCAVATED WALKWAY PRIOR TO PLACING GRANULAR MATERIALS.



Town of
East Gwillimbury

**STANDARD DUTY LIMESTONE
SCREENING WALKWAY**

STANDARD DETAIL

APPROVED	DWG. No.
REVISION No.	308
DATE 2009	

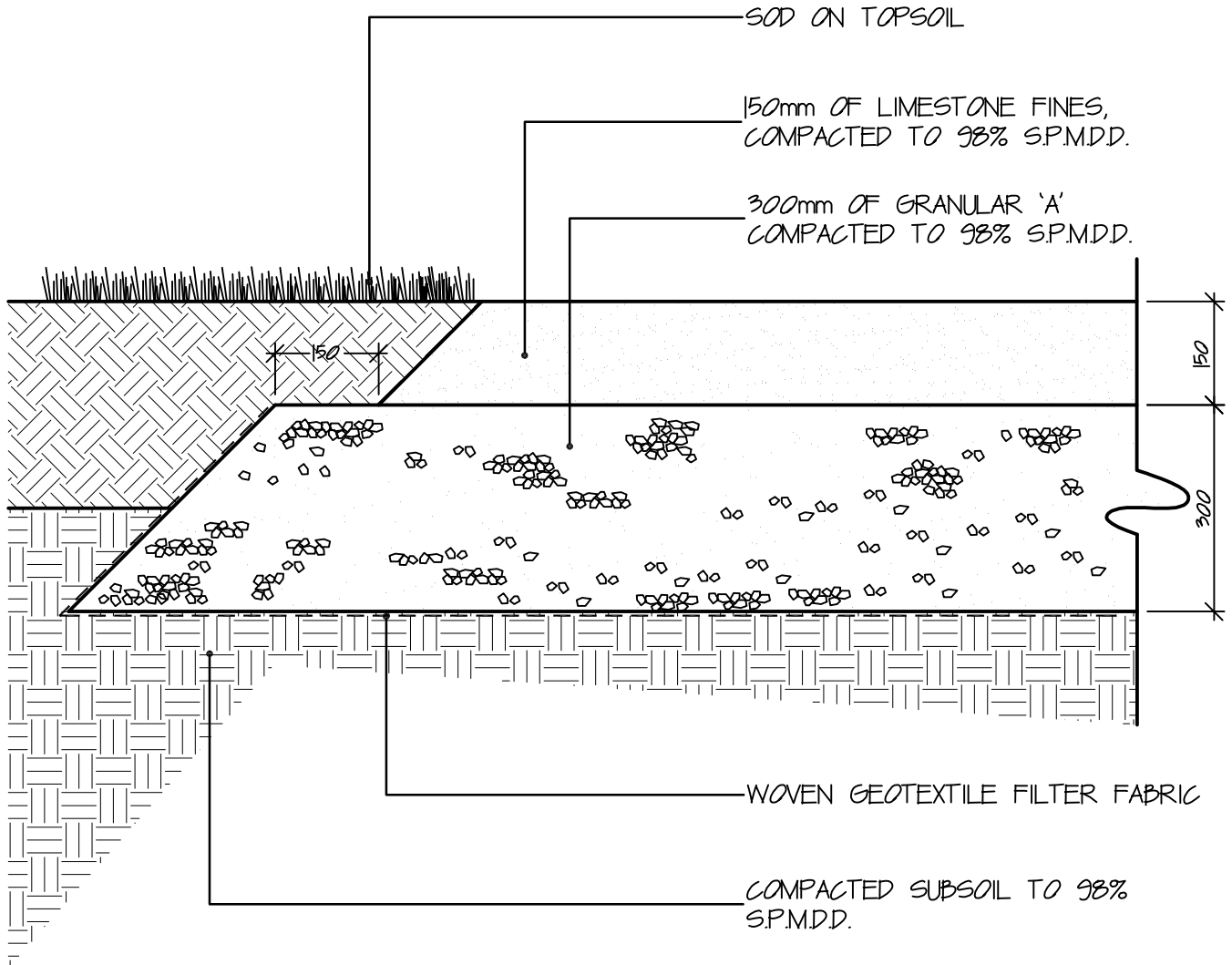

NOTE:

ENSURE THAT ALL ORGANIC MATTER IS REMOVED FROM THE EXCAVATED WALKWAY PRIOR TO PLACING GRANULARS.



Town of
East Gwillimbury

**HEAVY DUTY LIMESTONE
SCREENING WALKWAY**

STANDARD DETAIL

APPROVED

DWG. No.

REVISION No.

309

DATE

2009

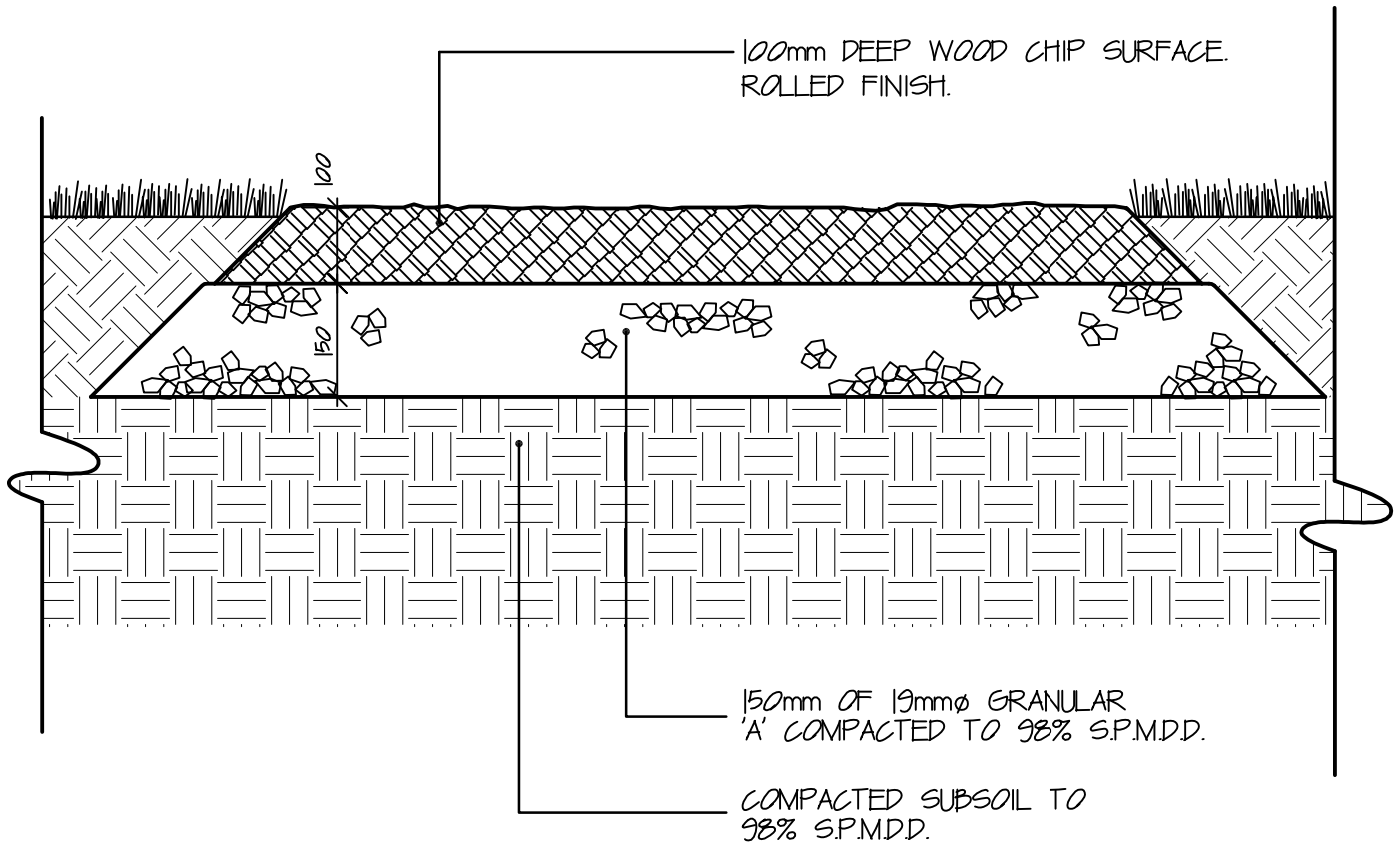

NOTE:

ENSURE THAT ALL ORGANIC MATTER IS REMOVED FROM THE EXCAVATED AREA PRIOR TO PLACING AND COMPACTION OF BASE MATERIALS.



Town of
East Gwillimbury

WOOD CHIP PATH

STANDARD DETAIL

APPROVED

DWG. No.

REVISION No.

310

DATE

2009

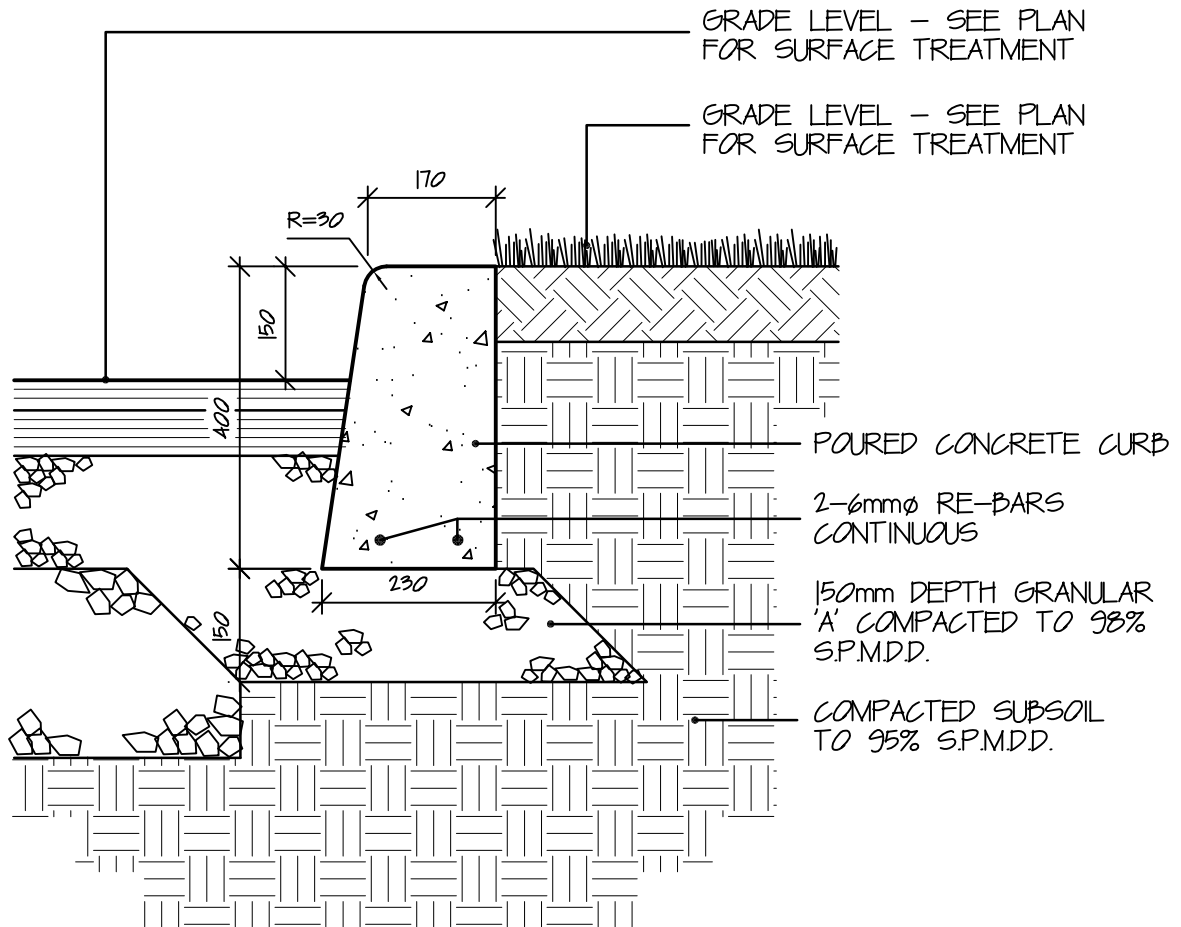

NOTES:

1-CONCRETE TO BE 30MP α COMPRESSIVE STRENGTH AT 25 DAYS WITH 5%-7% AIR ENTRAINMENT

2-PROVIDE EXPANSION JOINTS 4250 MAXIMUM SPACING

3-CURBS SHALL BE WOOD OR STEEL FORMED.



Town of
East Gwillimbury

CONCRETE CURB

STANDARD DETAIL

APPROVED

DWG. No.

REVISION No.

311

DATE

2009

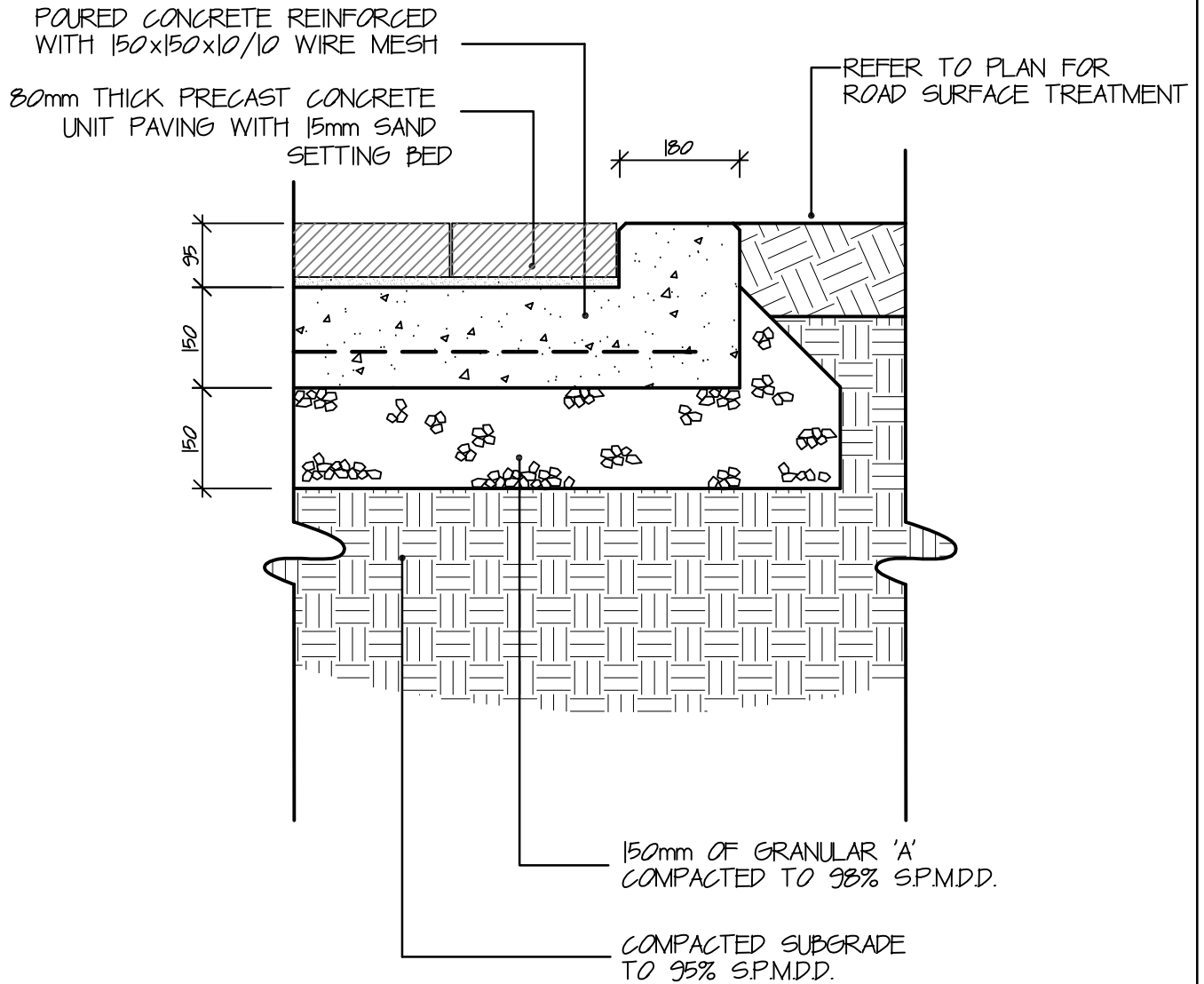

NOTES:

- 1-CONCRETE SHALL BE 30 MP_a AT 28 DAYS WITH 6% AIR ENTRAINMENT
- 2-REFER TO LAYOUT PLAN FOR LOCATION OF EXPANSION AND CONSTRUCTION JOINTS.
- 3-CURING MEMBRANE (WHITE PIGMENTED) TO BE APPLIED AT THE RATE OF 4sq.m/L.



Town of
East Gwillimbury

**CONCRETE EDGE
AT CROSSWALK**

STANDARD DETAIL

APPROVED

DWG. No.

REVISION No.

312

DATE

2009

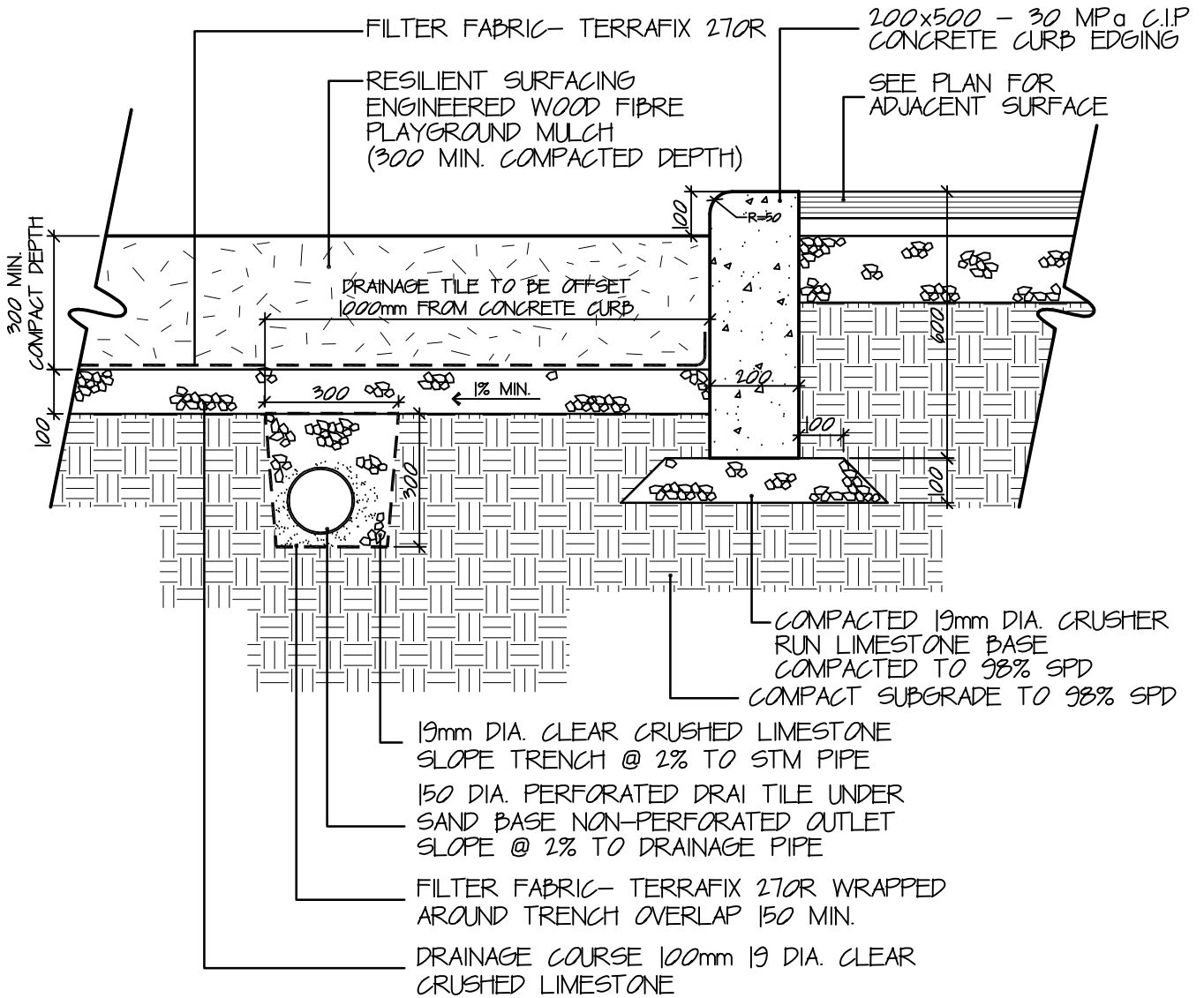

NOTES:

- 1—CONCRETE TO BE 35MPa COMPRESSIVE STRENGTH AT 25 DAYS WITH 5%-7% AIR ENTRAINMENT
- 2—PROVIDE EXPANSION JOINTS 4250 MAXIMUM SPACING, SEE SPECIFICATIONS
- 3—CURBS SHALL BE WOOD OR STEEL FORMED.
- 4—COLLECTOR LINES ARE 100Ø P.V.C. SDR-35 ON SAND BEDDING, 200mm DEPTH x 200mm WIDTH.
- 5—PERFORATED HOLES SHALL BE PLACED DOWN.
- 6—GENERAL CONTRACTOR IS RESPONSIBLE TO CO-ORDINATE WITH PLAYGROUND CONTRACTOR.
- 7—THE CONCRETE FOUNDATIONS AND POSTS OF ALL PLAY EQUIPMENT SHALL BE INSTALLED PRIOR TO THE INSTALLATION OF SAND AND AFTER THE SUBGRADE ELEVATIONS ARE ESTABLISHED



Town of
East Gwillimbury

**PLAY AREA CONCRETE
CURB & SUBSURFACE
DRAINAGE**

STANDARD DETAIL

APPROVED

DWG. No.

REVISION No.

313

DATE

2009

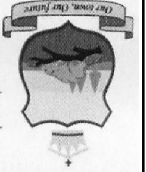

CONCRETE ACCESS RAMP

DATE 2009
REVISION No.
APPROVED COUNCIL

314

STANDARD DETAIL

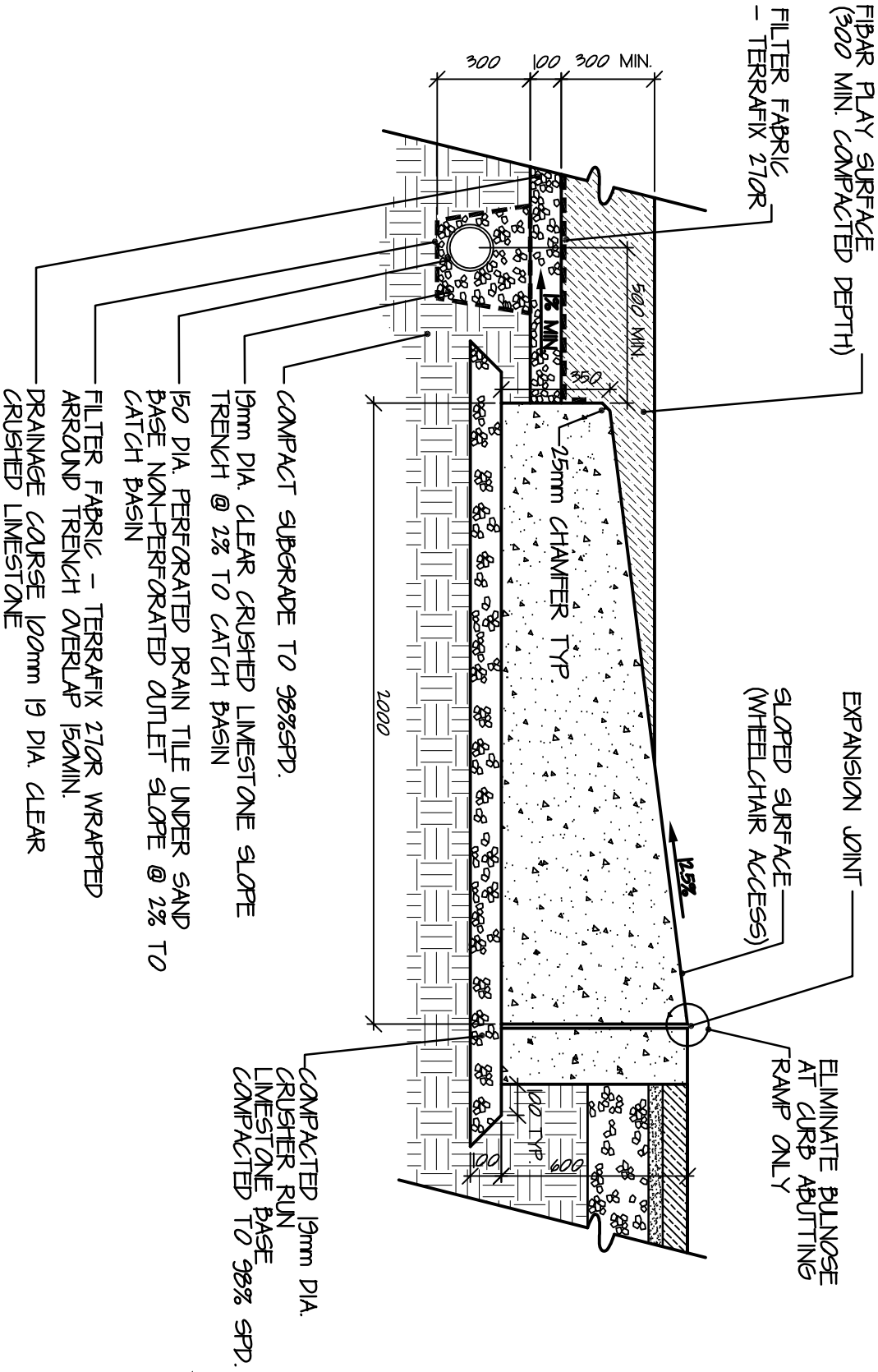

ALL DIMENSIONS IN MILLIMETRES AND/OR METRES, DRAWING NOT TO SCALE

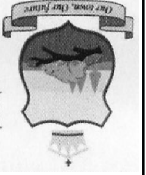

East Gwillimbury
Town of

TYPICAL WALKING & CYCLING TRAIL SECTION

DATE 2009

REVISION No.

APPROVED COUNCIL

DWG. No.

315

STANDARD DETAIL

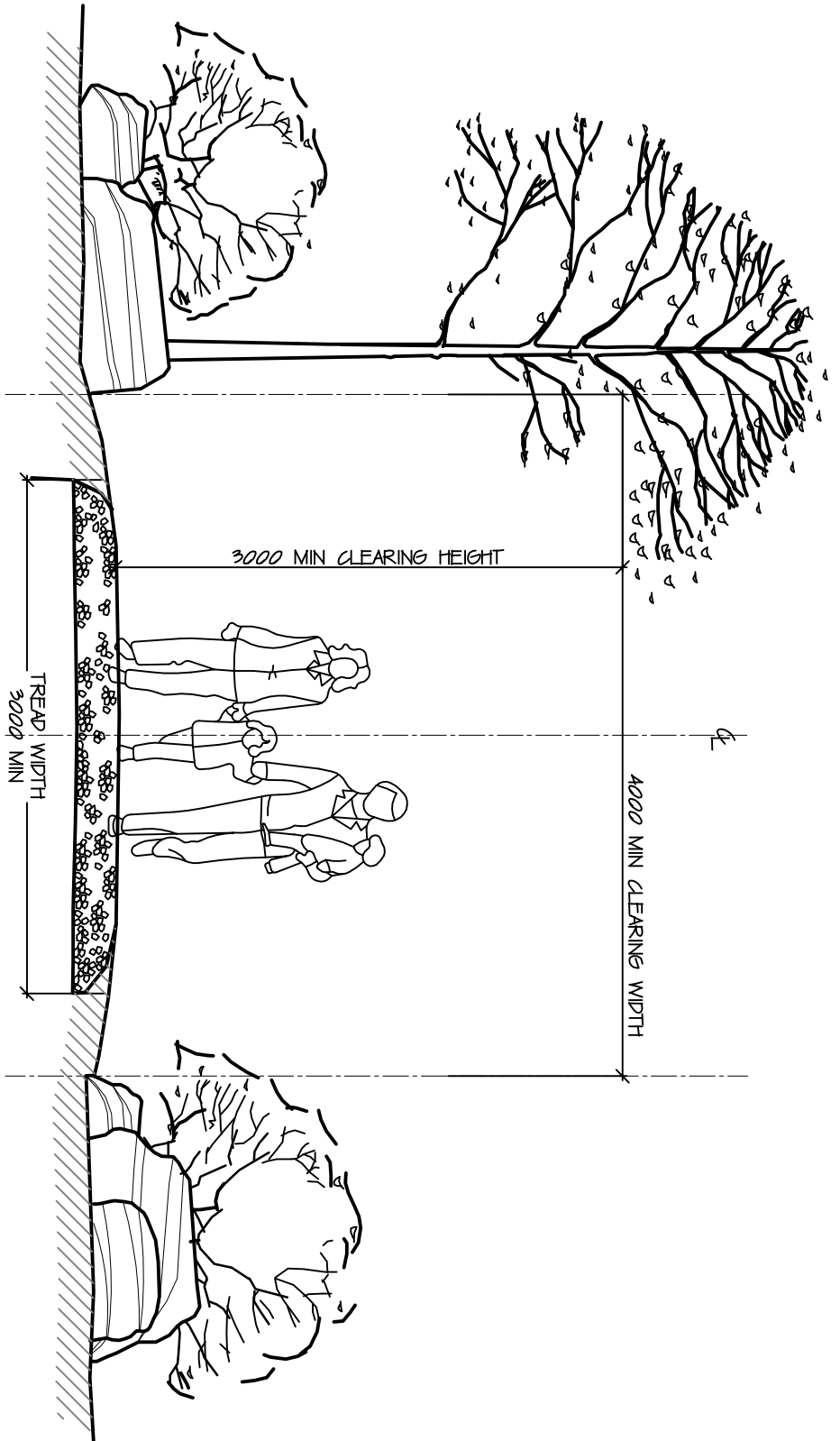

MINIMUM TRAIL STANDARD FOR A WALKING OR CYCLING TRAIL PROVIDED FOR A MODERATE LEVEL OF USE IS A CLEARED AND GRUBBED RIGHT OF WAY WITH A FIRM COMPACTED GRANULAR TREAD SURFACE, GENERALLY A CIRCULATION ROUTE BETWEEN ACTIVITY AREAS OR DESTINATIONS FEATURES IN CLOSE PROXIMITY TO DEVELOPMENT AREAS.

CLEARING WIDTH: 4.0 METRES MINIMUM
CLEARING HEIGHT: 3.0 METRES MINIMUM
TREAD WIDTH: 3.0 METRES MINIMUM
TREAD SURFACE: COMPACTED GRANULAR
DESIRABLE GRADE: 0 TO 3%
FORM: LINEAR FOR SERVICE ORIENTED TRAIL
LOOP FOR SCENIC TRAIL

CLEARING WIDTH: 4.0 METRES MINIMUM
CLEARING HEIGHT: 3.0 METRES MINIMUM
TREAD WIDTH: 3.0 METRES MINIMUM
TREAD SURFACE: COMPACTED GRANULAR
DESIRABLE GRADE: 0 TO 3%
FORM: LINEAR FOR SERVICE ORIENTED TRAIL
LOOP FOR SCENIC TRAIL